

# WINTER

Diamond grinding wheels  
for automatic circular sawblade  
grinding machines >WIDMA<  
Vollmer Werke GmbH, Biberach/Riß

## Creep feed grinding

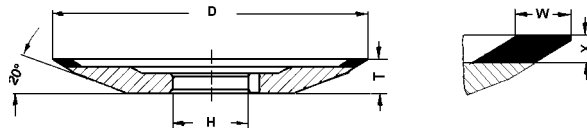

Shape	- D - W - X - H	Grit size	Bond	Concentration	ORDER No.	Remarks
<b>2K 12V2</b>	<b>- 100 - 4 - 2 - 25</b>	<b>D46</b>	<b>K-PLUS 921</b>	<b>C125A</b>	<b>82146032</b>	<b>T = 10</b> *)
		<b>D76</b>	<b>K-PLUS 4821</b>	<b>C125A</b>	<b>82103700</b>	<b>T = 10</b>
For grinding tooth faces. Machine type: BS 700 / HKS 700 / HKS 700/H-I / HKS 800 / UNIMAT		*) Also suitable for application with oil as cutting fluid.				
<b>2K 12V2</b>	<b>- 125 - 4 - 2 - 25</b>	<b>D46</b>	<b>K-PLUS 921</b>	<b>C125A</b>	<b>82146031</b>	<b>T = 11</b> *)
		<b>D76</b>	<b>K-PLUS 4821</b>	<b>C125A</b>	<b>82034738</b>	<b>T = 11</b>
For grinding tooth faces. Machine type: HKS 700/H-I / HKS 750 / grinding centre / Optimat		*) Also suitable for application with oil as cutting fluid.				
<b>5K 12V2</b>	<b>- 150 - 4 - 2 - 25</b>	<b>D76</b>	<b>K-PLUS 888RY</b>	<b>C125A</b>	<b>80119356</b>	<b>T = 13</b>
For grinding tooth faces. Machine type: BS 700 / HKS 700 / HKS 700/H-I / HKS 800 / UNIMAT						
Shape	- D - W - X - H	Grit size	Bond	Concentration	ORDER No.	Remarks
<b>1K 222</b>	<b>- 100 - 2 - 1.6 - 25</b>	<b>D76</b>	<b>K-PLUS 888RY</b>	<b>C125A</b>	<b>80116561</b>	
For grinding tooth faces. Machine type: BS 700 / HKS 700 / HKS 700 H-I / HKS 800 / UNIMAT						
<b>4K 222</b>	<b>- 125 - 3 - 1.8 - 25</b>	<b>D76</b>	<b>K-PLUS 888RY</b>	<b>C125A</b>	<b>80133003</b>	
For grinding tooth faces. Machine type: HKS 700/H-III / HKS 750 / grinding centre/ Optimat						

# WINTER

Diamond grinding wheels  
for automatic circular sawblade  
grinding machines >WIDMA<  
Vollmer Werke GmbH, Biberach/Riß

## Creep feed grinding

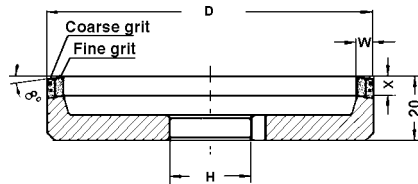

Shape	- D - W - X - H	Grit size	Bond	Concentration	ORDER No.	Remarks
<b>6K 222</b>	<b>-100 - 5 - 6 - 2B - 25</b>	D126 D46	K-PLUS 888RY	C100 C75	<b>80144288</b>	

For grinding tooth tops.  
Machine type: HKS 700 / HKS 700/H-I / HKS 700/H-III / HKS 750 / HKS 800

<b>9K 222</b>	<b>- 125 - 5 - 6 - 2B - 25</b>	D126 D46	K-PLUS 888RY	C100 C75	<b>80142668</b>	
---------------	--------------------------------	-------------	--------------	-------------	-----------------	--

For grinding tooth tops.  
Machine type: HKS 700 / HKS 700/H-I / HKS 700/H-III / HKS 750 / HKS 800 / grinding centre / Optimat / Supermat

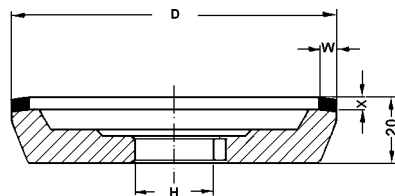

Shape	- D - W - X - H	Grit size	Bond	Concentration	ORDER No.	Remarks
<b>5K 222</b>	<b>- 100 - 5 - 4 - 25</b>	D76	K-PLUS 888RY	C75	<b>80142643</b>	

For grinding tooth tops in sharpening service.  
Machine type: UNIMAT

# WINTER

Diamond grinding wheels  
for automatic circular sawblade  
grinding machines >WIDMA<  
Vollmer Werke GmbH, Biberach/Riß

## Creep feed grinding

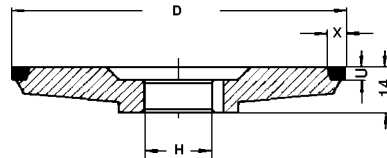

Shape	- D - U - X - H	Grit size	Bond	Concentration	ORDER No.	Remarks
<b>1K 700</b>	<b>- 100 - 4 - 4.5 - 20</b>	D91 D126	K-PLUS 730-42 K-PLUS 888NY	C50A C75A	<b>80112105</b> <b>80106177</b>	*)
For grinding tooth flanks (cutting width). *) Also suitable for application with oil as cutting fluid. Machine type: HKS 400 / FS 600 / FS 1000/H / FS 1001 / grinding centre						
<b>2K 700</b>	<b>- 100 - 4 - 6.5 - 20</b>	D126	K-PLUS 888NY	C75A	<b>80102394</b>	
For grinding tooth flanks (cutting width). Machine type: HKS 400 / FS 600 / FS 1000/H / FS 1001/H / grinding centre						